

# Alberto Dressing Table

Assembly instructions



Basic



30 - 40  
Minutes



## Parts

**Carton 1 - Carcass**

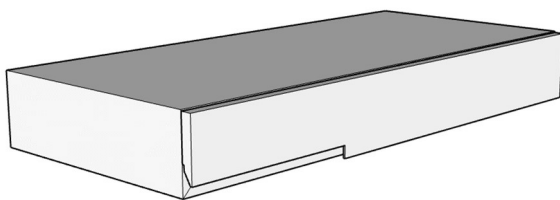

**Carton 2 - Glass top**

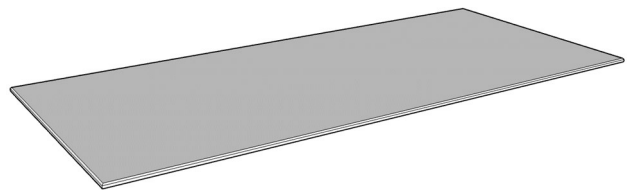

**Carton 3 - Frame, Back plate & Finger plate**



## Hardware

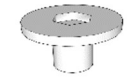

**Item A** – 16 x M5/10mm

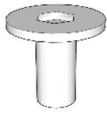

**Item B** – 4 x M5/20mm



**Item C** – 4 x Suction cups



**Item D** – 3 x Round Stickers



**Item E** – 3 x Small Screws



**Item F** – Hex Key

## Assembly Stages

### Stage 1 – Fit the Frame to the Drawer Carcass

Using the hardware Specified below fit the base to the bottom of the drawer unit. Use **Item A** on the side fixings and **Item B** on the strut bars

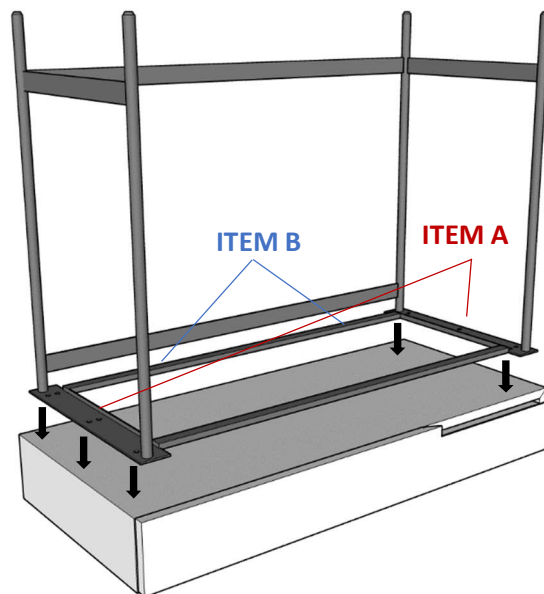
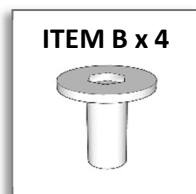
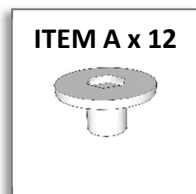

### Stage 2 – Remove the Drawer front

You will need to remove the drawer front to attach the finger plate. For this you will need a Phillips screwdriver. Open the drawer and unscrew the bolts on the inside of the drawer.

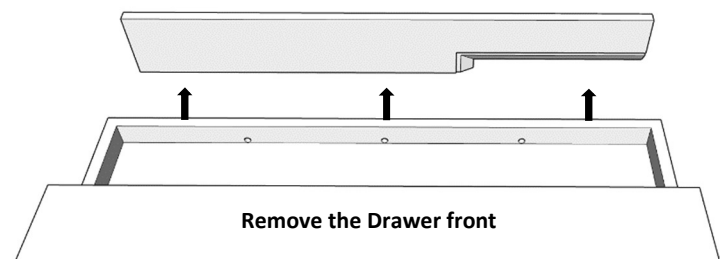
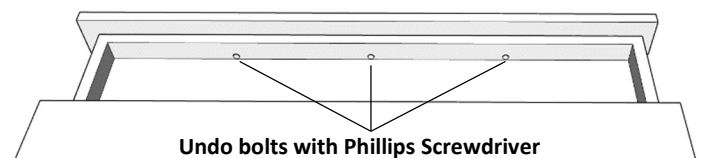

### Stage 3 – Attach the Finger plate

Using the 3 x Small Screws (Item E) and a Phillips screwdriver, attach the finger plate to the drawer front.

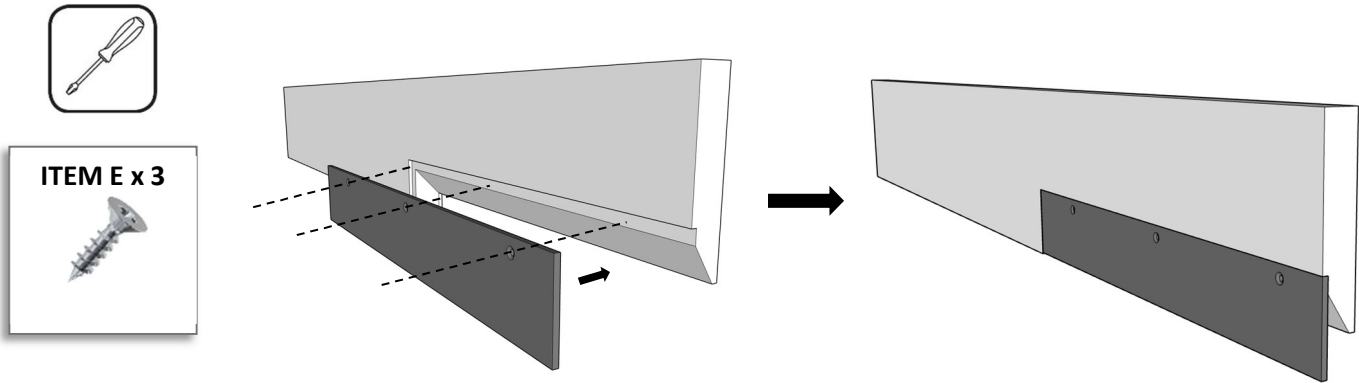

### Stage 4 – Re attach the Drawer front

Now the finger plate is attached, re attach the drawer front using the x3 bolts that were undone to remove the drawer front.

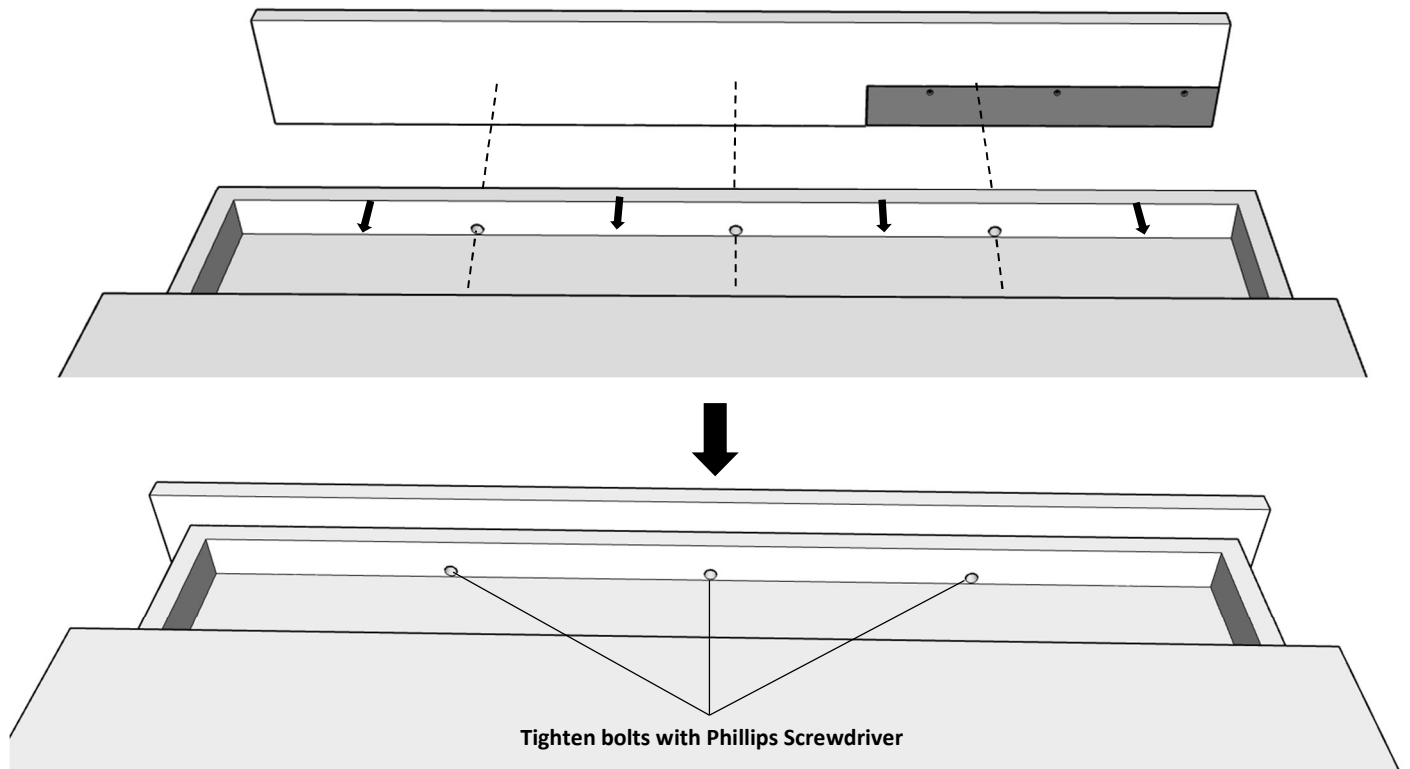

### Stage 5 – Fixing the bolts for Back plate

Take the remaining bolts from **Item A (x4)**. Screw these halfway into the fixing points on the back of the carcass. Illustrated below.

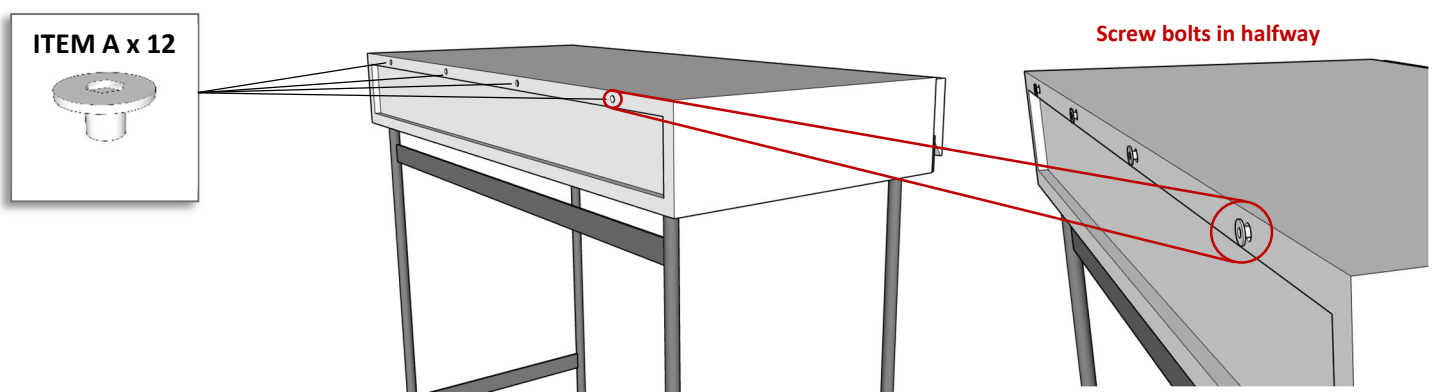

### Stage 7 – Fit the Back Plate

Take the **Back plate** and drop it down onto the bolts you have half screwed in. Once in place tighten the bolts so the **Back plate** is tight to the carcass.

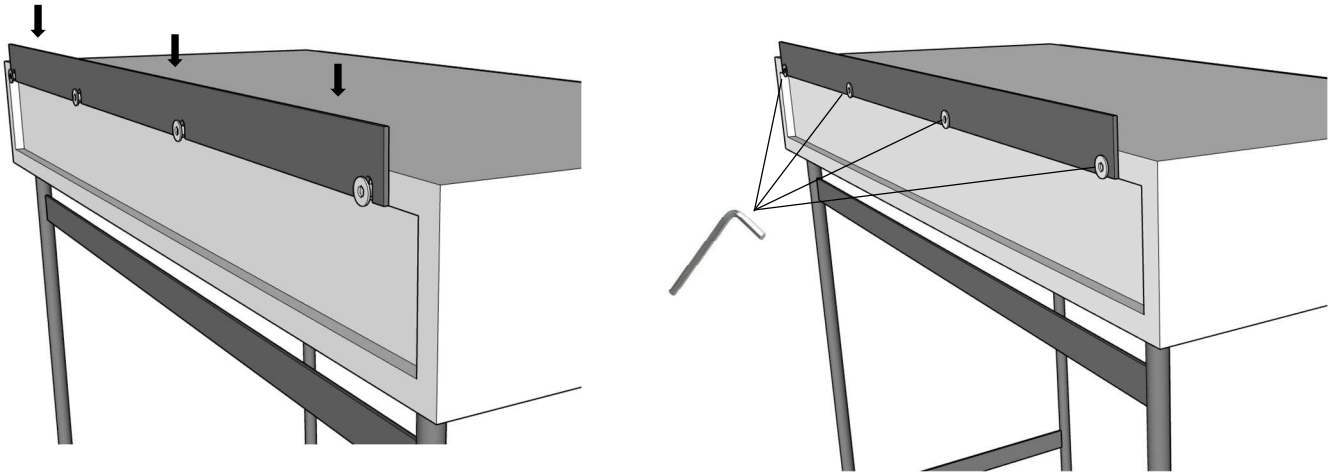

### Stage 8 – Place the glass

Place **Items C** onto each corner of the carcass and then put the top in place and press down lightly so the suckers compress and hold the top in place.

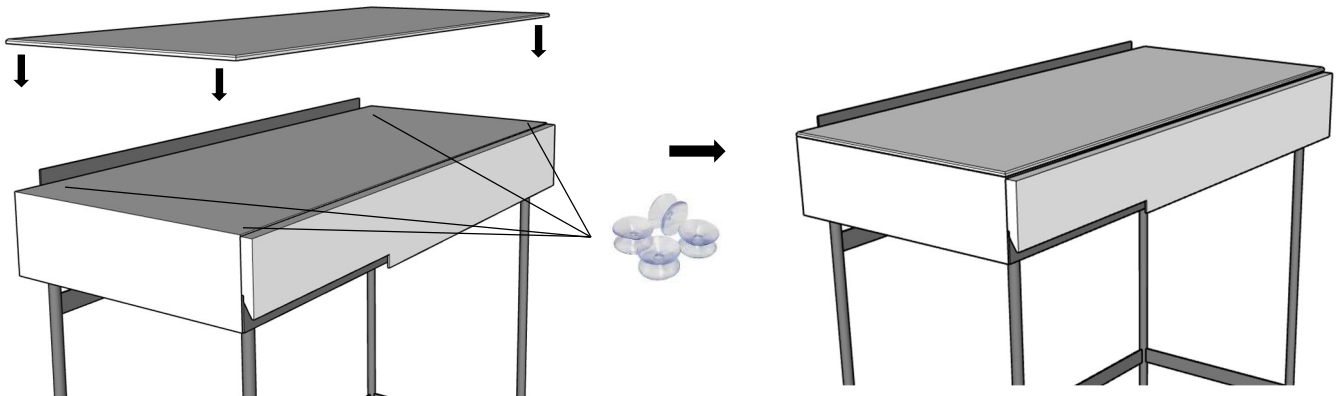

### Complete

